



17 Computer Drive West
Albany, NY 12205
518.438.9900

70 Linden Oaks, Third Floor, Suite 15
Rochester, NY 14625
585.866.1000

Via Electronic Delivery

November 11, 2023

North Syracuse Fire Department
109 Chestnut Street
North Syracuse, NY 13212

Attention: Paul Linnertz

**Re: Response to Comments Summary
Proposed Chick-fil-A Redevelopment
110 E Taft Road**

Dear Mr. Linnertz,

On behalf of our client, Chick-fil-A, Inc., we are pleased to submit this response to comments summary to the North Syracuse Fire Department for the above referenced project. This summary is in response to the various comments received in the November 6, 2023 letter from Paul Linnertz with the North Syracuse Fire Department, as noted below with our responses in italics. Please find the following items in support of our application:

- A. One (1) copy of the updated "Fire Truck Turning Exhibit" prepared by Bohler Engineering, dated 02/08/2022, last revised 11/07/2023
- B. One (1) copy of the updated "Plumbing Site Plan" prepared by Bohler Engineering, dated 02/08/2022, last revised 11/07/2023

Response to various comments summary as follows:

A. Fire Apparatus Access Road

503.2.4 Turning radius. The required turning radius of a fire apparatus access road shall be determined by the fire code official.

The entrance to the site from South Bay Road appears restricted. The striped concrete island creates a turning issue for fire apparatus.

Traveling north on the site creates an acute turn of less than 90 degrees to the left. Looking at the insert labeled "Delivery and emergency vehicle circulation exhibit" on sheet C-2.1 it is clear there is not enough room to safely operate a fire apparatus in this space. It is never appropriate to imply that fire apparatus should drive through parking spaces, that may be occupied, as part of a fire apparatus access road. I have included the turning radius of one of our engines for your use.

The fire truck turning exhibit has been updated with the provided fire apparatus specifications and is attached to this submission. As shown, the fire truck can adequately navigate the site without conflicting with parking spaces. The drive aisle at the turn noted to be a concern due to a more than 90 degree movement has been widened with a striped off area of pavement to provide more maneuvering room. The curbed islands at the entrance to South Bay are mountable as well

BOHLER //

North Syracuse Fire Department
109 Chestnut Street
North Syracuse, NY 13212

November 7, 2023
Page 2 of 2

should additional turning room be necessary. Note the previously reviewed turning movement was for a WB-67 Tractor Trailer for store deliveries which occur when the store is closed.

B. Fire Protection Water Supply.

507.5.1 Where required. Where a portion of the facility or building hereafter constructed or moved into or within the jurisdiction is more than 400 feet (122 m) from a hydrant on a fire apparatus access road, as measured by an **approved** route around the exterior of the facility or building, on-site fire hydrants and mains shall be provided where required by the fire code official.

Exceptions:

1. For Group R-3 and Group U occupancies, the distance requirement shall be 600 feet (183 m).
2. For buildings equipped throughout with an approved automatic sprinkler system installed in accordance with Section 903.3.1.1 or 903.3.1.2, the distance requirement shall be 600 feet (183 m).

The proposed plan does not meet the intent of the Fire Code. The only entrance to the site is South Bay Road. There are no fire hydrants on S. Bay Road in this area. There is no fire hydrant on a fire apparatus access road within 400 feet of the exterior building. A fire hydrant will be required to be installed possibly around the proposed flag pole. Although there are no water mains shown on the site plan, a 12-inch water main is located on the east shoulder of US Route 11.

A fire hydrant has been added to the plans and the updated Plumbing Site Plan is attached with this submission. The hydrant is now proposed by the Drive Thru entrance along East Taft Road

Should you have any questions or any additional needs please do not hesitate to contact us at (518) 438-9900.

Sincerely,

BOHLER ENGINEERING AND LANDSCAPE ARCHITECTURE NY, PLLC



Timothy C. Freitag, P.E.



REVISIONS	
NO.	DESCRIPTION
1	
2	
3	
4	
5	
6	
7	
8	
9	
10	
11	
12	
13	
14	

BOHLER
 BOHLER //

BOHLER //

15 CHATEAU BLVD. SUITE 100
 WEST HAVEN, CT 06490
 TEL: 203.399.1100
 FAX: 203.399.1101
 WWW.BOHLERFIRETRUCKS.COM

Series P13-D10-SQ
 MAP 14.16.1, LOT 14.1.4.2
 MAP 14.16.1, LOT 14.1.4.3
 MAP 14.16.1, LOT 14.1.4.4
 MAP 14.16.1, LOT 14.1.4.5
 MAP 14.16.1, LOT 14.1.4.6
 MAP 14.16.1, LOT 14.1.4.7
 MAP 14.16.1, LOT 14.1.4.8
 MAP 14.16.1, LOT 14.1.4.9
 MAP 14.16.1, LOT 14.1.4.10
 MAP 14.16.1, LOT 14.1.4.11
 MAP 14.16.1, LOT 14.1.4.12
 MAP 14.16.1, LOT 14.1.4.13
 MAP 14.16.1, LOT 14.1.4.14
 MAP 14.16.1, LOT 14.1.4.15
 MAP 14.16.1, LOT 14.1.4.16
 MAP 14.16.1, LOT 14.1.4.17
 MAP 14.16.1, LOT 14.1.4.18
 MAP 14.16.1, LOT 14.1.4.19
 MAP 14.16.1, LOT 14.1.4.20
 MAP 14.16.1, LOT 14.1.4.21
 MAP 14.16.1, LOT 14.1.4.22
 MAP 14.16.1, LOT 14.1.4.23
 MAP 14.16.1, LOT 14.1.4.24
 MAP 14.16.1, LOT 14.1.4.25
 MAP 14.16.1, LOT 14.1.4.26
 MAP 14.16.1, LOT 14.1.4.27
 MAP 14.16.1, LOT 14.1.4.28
 MAP 14.16.1, LOT 14.1.4.29
 MAP 14.16.1, LOT 14.1.4.30
 MAP 14.16.1, LOT 14.1.4.31
 MAP 14.16.1, LOT 14.1.4.32
 MAP 14.16.1, LOT 14.1.4.33
 MAP 14.16.1, LOT 14.1.4.34
 MAP 14.16.1, LOT 14.1.4.35
 MAP 14.16.1, LOT 14.1.4.36
 MAP 14.16.1, LOT 14.1.4.37
 MAP 14.16.1, LOT 14.1.4.38
 MAP 14.16.1, LOT 14.1.4.39
 MAP 14.16.1, LOT 14.1.4.40
 MAP 14.16.1, LOT 14.1.4.41
 MAP 14.16.1, LOT 14.1.4.42
 MAP 14.16.1, LOT 14.1.4.43
 MAP 14.16.1, LOT 14.1.4.44
 MAP 14.16.1, LOT 14.1.4.45
 MAP 14.16.1, LOT 14.1.4.46
 MAP 14.16.1, LOT 14.1.4.47
 MAP 14.16.1, LOT 14.1.4.48
 MAP 14.16.1, LOT 14.1.4.49
 MAP 14.16.1, LOT 14.1.4.50

SHEET TITLE
FIRE TRUCK TURNING EXHIBIT

Preliminary
 80% Submittal
 For Construction

Job No. : 20090250
 Store : 404500
 Date : 02/09/2022
 Drawn By : JRB
 Checked By : JCE
 Sheet

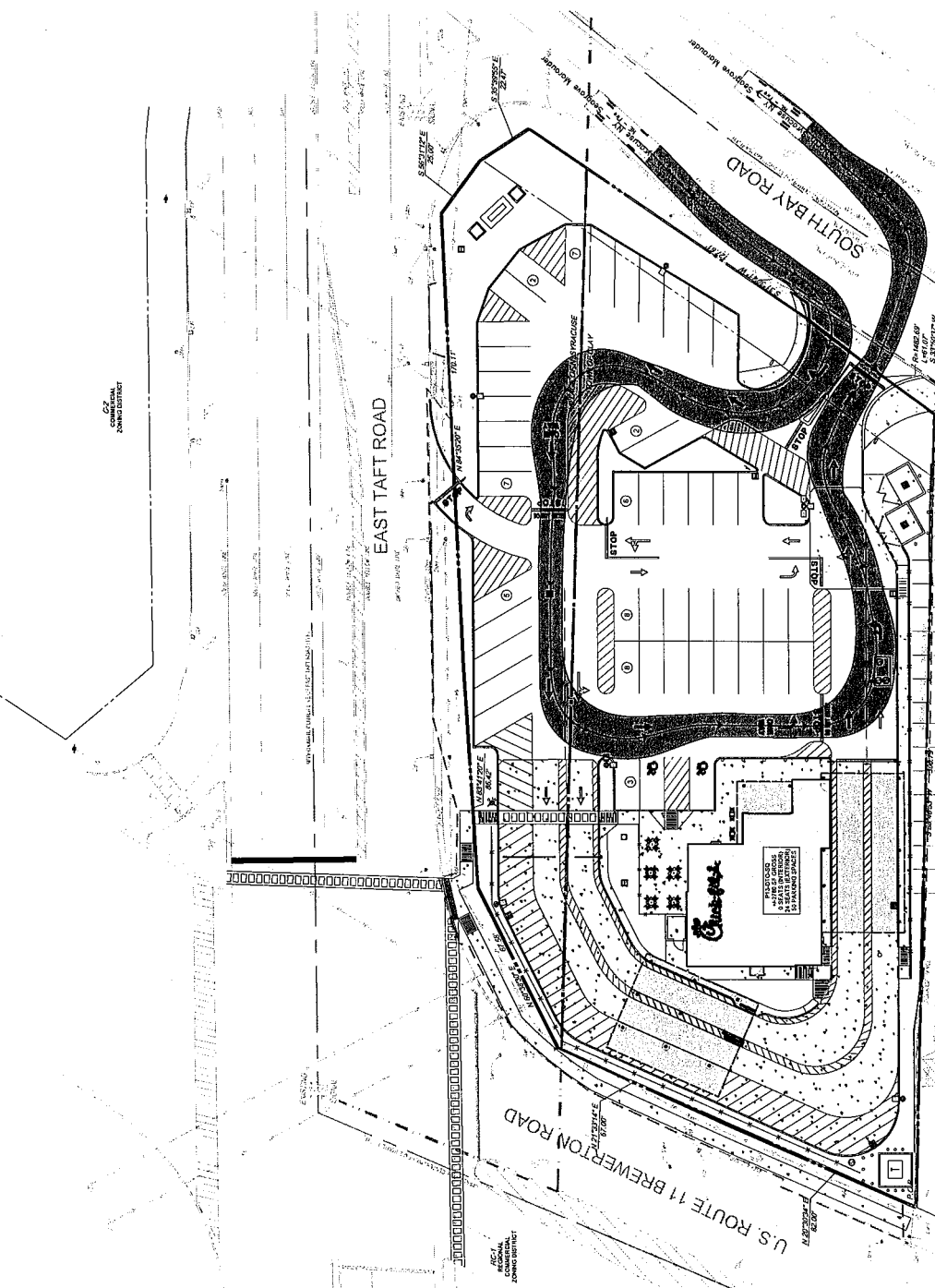
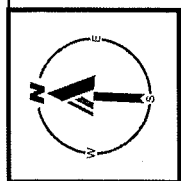

LANDSCAPE OF
 FLOUNDER 40, LLC
 BK 5000, PG. 103
 SECTION 14.16.1, LOT 4.1
 U.S. ROUTE 11 BREWERTON ROAD
 SEWER ZONING DISTRICT

